

1857 Wuerttembergisch Rifle

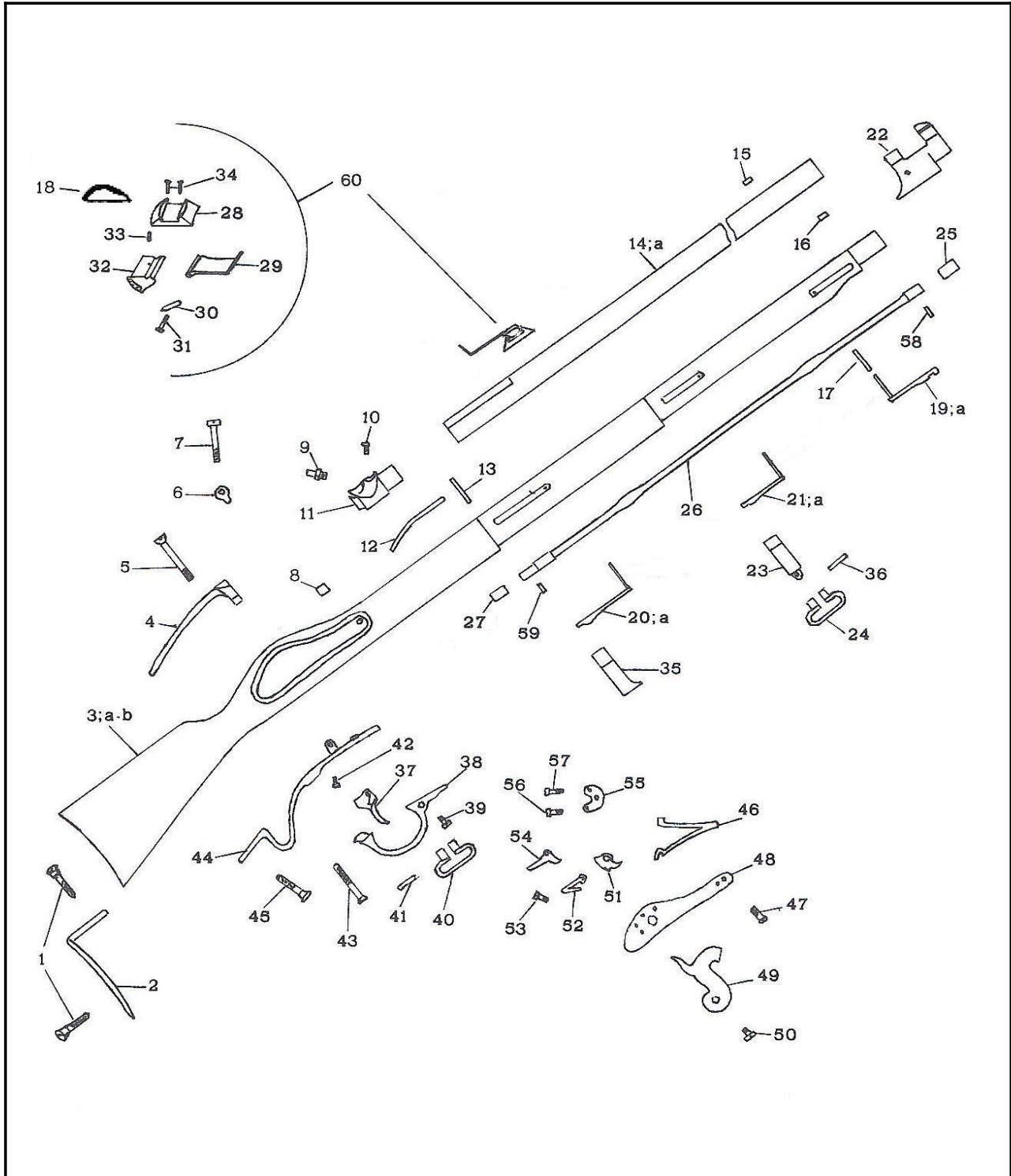

| Nomenclatura / List / Liste | | | | Codice Reference |
|------------------------------------|------------------------------------|----------------------------------|-----------------------------------|-------------------------|
| No. | Italiano | English | Français | Référence |
| 1 | Vite calciolo | Butt plate screw | Vis de plaque de couche | M70LFC5211 |
| 2 | Calciolo | Butt plate | Plaque de couche | 080002468 |
| 3 | Calcio | Stock | Monture | 080003433 |
| 3a | Calcio finito | Stock, finished | Monture ouvragé | 080003433A |
| 3b | Calcio completo | Stock with spares | Monture complète | 080003433B |
| 4 | Codetta | Tang | Queue de culasse | 080002467 |
| 5 | Vite codetta | Tang screw | Vis de queue de culasse | M70PFM5203 |
| 6 | Controcartella | Side plate | Contre-platine | 080002484 |
| 7 | Vite cartella | Lock plate screw | Vis de platine | M70PFM5209 |
| 8 | Zocchetto cartella | Retaining nut | Ecrou vis anteriore de platine | 080005298 |
| 9 | Luminello | Nipple | Cheminée | 080003408 |
| 10 | Vite tappo canna | Breech plug screw | Vis de bouchon de culasse | M70PFC5407 |
| 11 | Tappo canna | Breech plug | Bouchon de culasse | 080004806 |
| 12 | Molla bacchetta | Ramrod spring | Ressort de baguette | 080003702 |
| 13 | Copiglia molla bacchetta | Ramrod spring pin | Goupille du ressort de baguette | M70COP5378 |
| 14 | Canna | Barrel | Canon | 080002454 |
| 14a | Canna completa | Barrel with spares | Canon complet | 080002454B |
| 15 | Fermo fascetta anteriore | Front band lug | Arrêt du embouchoir | 080002919 |
| 16 | Fermo baionetta | Bayonet lug | Tenon de baïonnette | 080002918 |
| 17 | Bussola molla fascetta anteriore | Front band spring bush | Coupille ressort embouchoire | 080002175 |
| 18 | Rampa tacca di mira | Rear sight ramp | Rampe de hausse | 080004502 |
| 19 | Molla fascetta anteriore | Front band spring | Ressort du embouchoir | 080003628 |
| 19a | Copiglia molla fascetta anteriore | Front band spring pin | Goupille du ressort du embouchoir | |
| 20 | Molla fascetta posteriore | Middle band spring | Ressort de grenadière | 080003650 |
| 20a | Copiglia molla fascetta posteriore | Rear band spring pin | Goupille du ressort de capucine | |
| 21 | Molla fascetta intermedia | Rear band spring | Ressort de capucine | 080003627 |
| 21a | Copiglia molla fascetta intermedia | Middle band spring pin | Goupille du ressort du grenadière | |
| 22 | Fascetta anteriore | Front band | Embouchoir | 080002975 |
| 23 | Fascetta intermedia | Middle band | Grenadière | 080002976 |
| 24 | Portacinghia anteriore | Front swivel | Battant antérieur | 080004245 |
| 25 | Puntale anteriore bacchetta | Front ramrod ferrule | Refouloir | 080002232 |
| 26 | Bacchetta | Ramrod | Baguette | |
| 27 | Puntale posteriore bacchetta | Rear ramrod ferrule | Embout postérieur baguette | 080002233 |
| 28 | Base tacca di mira | Rear sight base | Pied de l'hausse | |
| 29 | Tacca di mira | Rear sight | Cran de mire | 080004825 |
| 30 | Indicatore tacca di mira | Rear sight pointer | Indicateur du cadran gradué | 080003202 |
| 31 | Vite tacca di mira | Rear sight screw | Vis du cran de mire | M70TFM5217 |
| 32 | Supporto tacca di mira | Rear sight graduated stand | Cadran gradué | 080004612 |
| 33 | Vite supporto tacca di mira | Rear sight graduated stand screw | Vis du cadran gradué | M700ST5216 |
| 34 | Vite base tacca di mira | Rear sight base screw | Vis fixation hausse | M70PFC5403 |
| 35 | Fascetta posteriore | Rear band | Capucine | 080002977 |
| 36 | Copiglia portacinghia anteriore | Front swivel pin | Goupille du battant antérieur | M70COP5201 |
| 37 | Grilletto | Trigger | Détente | 080003022 |
| 38 | Guardamano | Trigger guard | Pontet | 080003020 |
| 39 | Vite guardamano | Trigger guard screw | Vis du pontet | M70TFM5204 |
| 40 | Portacinghia posteriore | Rear swivel | Battant postérieur | 080004246 |
| 41 | Copiglia portacinghia posteriore | Rear swivel pin | Goupille du battant postérieur | M70COP5202 |
| 42 | Vite grilletto | Trigger screw | Vis de détente | M70TFM5310 |
| 43 | Vite sottoguardia/codetta | Trigger plate screw | Vis de sous-garde | M70TFM5208 |
| 44 | Sottoguardia | Trigger plate | Sous-garde | 080004606 |
| 45 | Vite posteriore sottoguardia | Rear trigger plate screw | Vis postérieure de sous-garde | M70LFM5324 |
| 46 | Molla cane | Mainspring | Grand ressort | 080003625 |
| 47 | Vite anteriore cartella | Front lock plate screw | Vis antérieure de platine | M70PFM5210 |
| 48 | Cartella | Lock plate | Platine | 080002480 |
| 49 | Cane | Hammer | Chien | 080002483 |
| 50 | Vite cane | Hammer screw | Vis du chien | M70PFC5206 |
| 51 | Noce | Tumbler | Noix | 080003905 |

| Nomenclatura / List / Liste | | | | Codice Reference |
|------------------------------------|---------------------------------------|--------------------------|-------------------------------------|-----------------------------|
| No. | Italiano | English | Français | Référence |
| 52 | Molla leva scatto | Sear spring | Ressort de gâchette | 0800003626 |
| 53 | Vite molla leva scatto | Sear spring screw | Vis du ressort de gâchette | M70PFM5213 |
| 54 | Leva scatto | Sear | Gâchette | 0800003419 |
| 55 | Braghetta | Bridle | Bride | 0800002214 |
| 56 | Vite leva scatto | Sear screw | Vis de gâchette | M70PFM5215 |
| 57 | Vite braghetta | Bridle screw | Vis de bride | M70PFM5212 |
| 58 | Copiglia puntale anteriore bacchetta | Front ramrod ferrule pin | Goupille refouloir | M70COP5228 |
| 59 | Copiglia puntale posteriore bacchetta | Rear ramrod ferrule pin | Goupille embout postérieur baguette | M70COP5227 |
| 60 | Tacca di mira completa | Rear sight assembled | Hausse complète | 080004825B |